

BRING YOUR CLASSROOM TO LIFE WITH THE POWER OF BLACKBOARD AND WIMBA

Online collaboration holds many promises for education: more student engagement, more equitable access for all students, and opportunities for teachers to further their own learning. However, text-based collaboration can feel stifling and many web-based collaboration solutions are difficult to manage. The **Wimba Collaboration Suite Express™** for the Blackboard Academic Suite™ provides a collaborative learning environment for K-12 institutions that provides flexible professional development options, expands learning opportunities, strengthens learning communities, and addresses diverse learning styles.

INTRODUCING WIMBA COLLABORATION SUITE EXPRESS

Wimba Collaboration Suite Express is a free, introductory license of the Wimba Collaboration Suite™ for Blackboard K-12 customers and includes limited versions of Wimba Classroom™, Wimba Voice™ and Wimba Pronto™. By extending Blackboard with Wimba, your school or district can:

- Provide flexible professional development options for teachers by offering continuous anytime, anyplace learning to accommodate their busy schedules.
- Expand learning opportunities for students regardless of where they live, how they learn or what is available to them at their local school.
- Strengthen learning communities with voice discussion boards, virtual classrooms and academic-centric instant messaging.
- Address diverse learning styles through adaptable and varied instructional methods.

Wimba expands the rich teaching and learning environment of Blackboard by adding an easy and powerful platform for synchronous collaboration. We are excited to see our students using the two technologies together for dialogue that facilitates understanding and enables their success.

*Jed Friedrichsen
Chief Administrative Officer
blendedschools.net*

The screenshot displays the Wimba Classroom Express interface within a Blackboard environment. The main content area features a red background with the title "Algebraic Model" and a definition: "A mathematical statement with variables and math symbols." Below this, the formula $A=bh$ is shown, with a yellow circle highlighting it. A text box explains the variables: "where: A= area, b=length of base, h=height". A yellow callout box asks, "You must tell what each variable stands for!". The interface includes a left-hand navigation menu with options like "Announcements", "Class Information", and "Assignments". A top navigation bar shows "Home", "Help", and "Logout". A bottom chat window shows a conversation between users.

WIMBA COLLABORATION SUITE EXPRESS™ INCLUDES

Wimba VOICE EXPRESS

Give Your Students a Voice

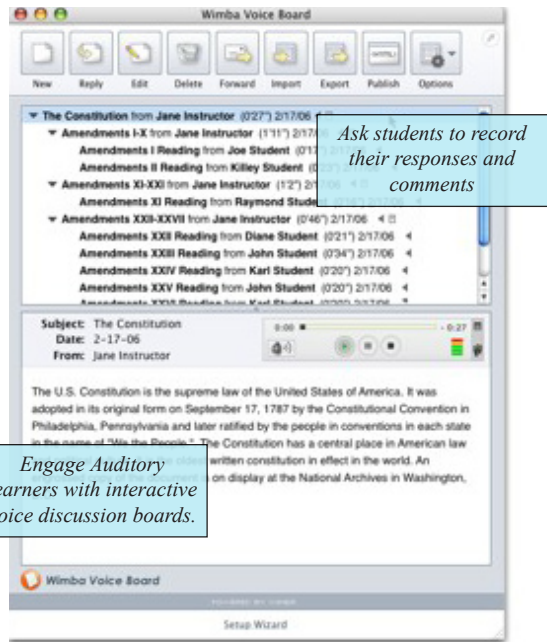

Wimba PRONTO EXPRESS

Expand Communication with Academic-Centric Instant Messaging

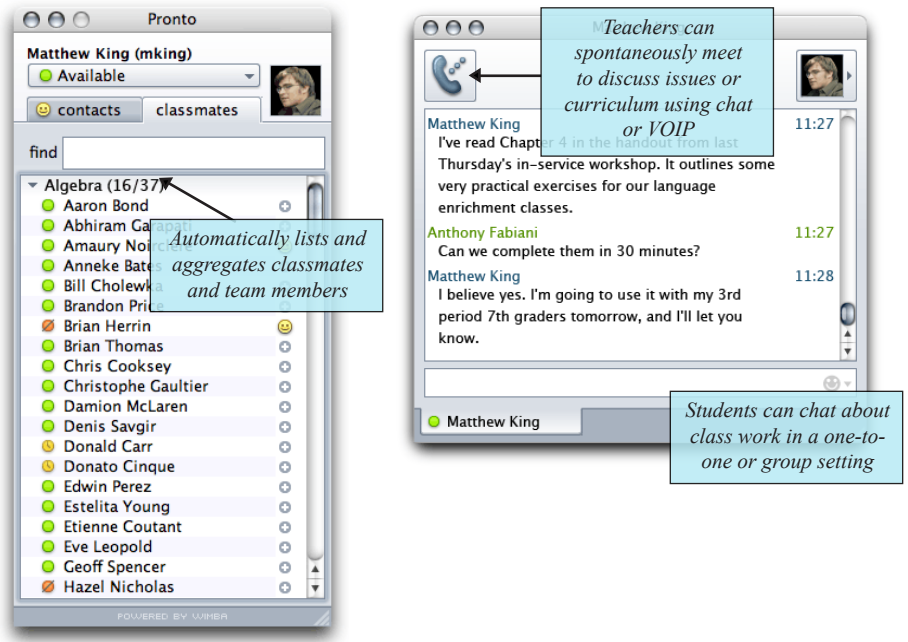

Wimba CLASSROOM EXPRESS

Bring Your Classroom to Life

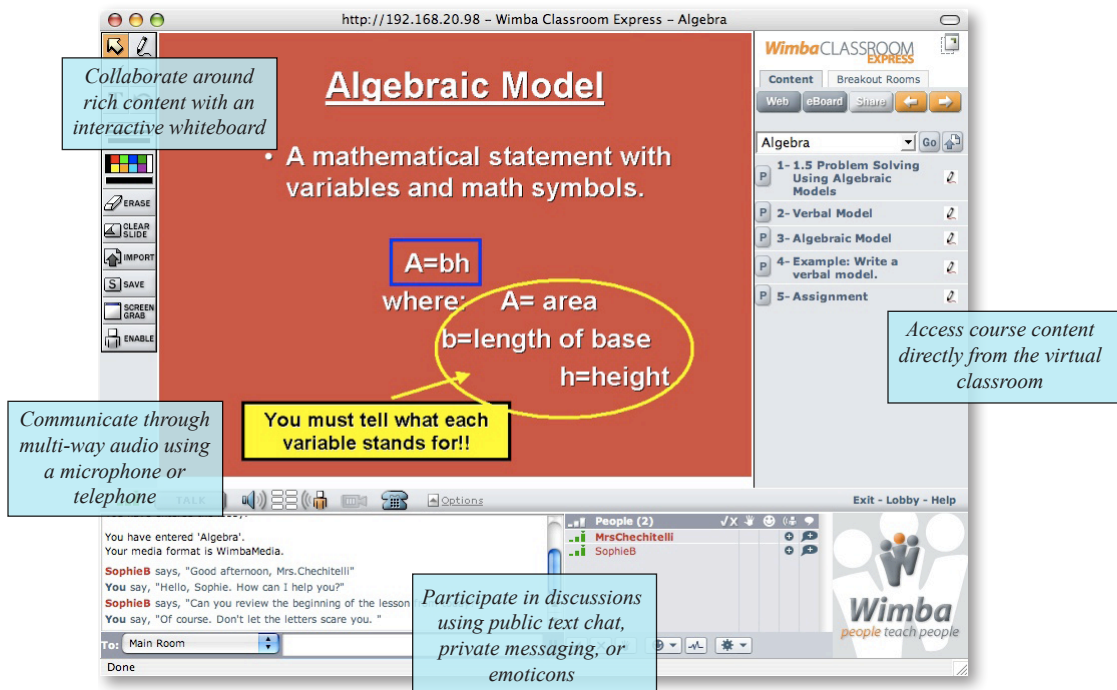

FOR MORE INFORMATION

The Wimba Collaboration Suite Express is available for no additional cost for Blackboard K-12 customers. To learn more about bringing your classroom to life with the power of Blackboard and Wimba, please visit www.blackboard.com/k12/collaborativelearning or email us at wimbaexpress@wimba.com.



© 2008 Blackboard Inc. Blackboard, the Blackboard logo, Bb, Blackboard Academic Suite, Blackboard Learning System, Blackboard Content System, and Blackboard Scholar are all trademarks or registered trademarks of Blackboard Inc. in the United States and/or other countries. All rights reserved. U.S. Patent No. 6,988,138.

www.blackboard.com
Worldwide Headquarters
1899 L Street, NW 11th Floor
Washington, DC 20036
1-800-424-9299, ext. 4